

name:

BENCH - BACK EXTENDER

SKU:

TEL002-5 S

description:

The exercise strengthens the back muscles, which stabilize and extend the spine. It also engages the glutes and the hamstrings.

Working muscles:

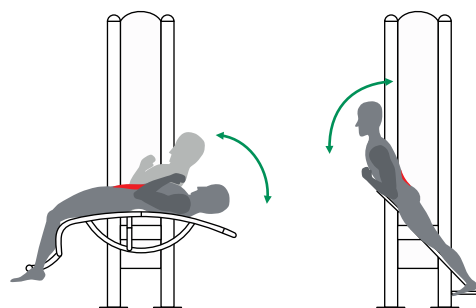

dimensions (L x W x H):

195 x 143 x 100 cm

safety zone:

495 x 443 cm

technical specifications:

- Steel pipes, galvanized, min. 3mm thick
- The diameter of the pipes 33, 38, 42, 60, 90, 114mm
- Twice powder-coated
- Plastic handles
- Bearings closed, stainless steel screws
- The seat, backrest and perforated treads from black steel; galvanized and powder-coated or from stainless steel, min. 3mm thick



MAX
160 kg

min.
1,4m

available colors: (and many others according to RAL)

7040

3020

7040

5003

7040

1003

7040

6005

7012

2003